

SOLEIL

---

# SOLEIL



---

UNWIND ON THE NILE AS YOU EXPLORE TIMELESS WONDERS  
AND INDULGE IN UNPARALLELED LUXURY

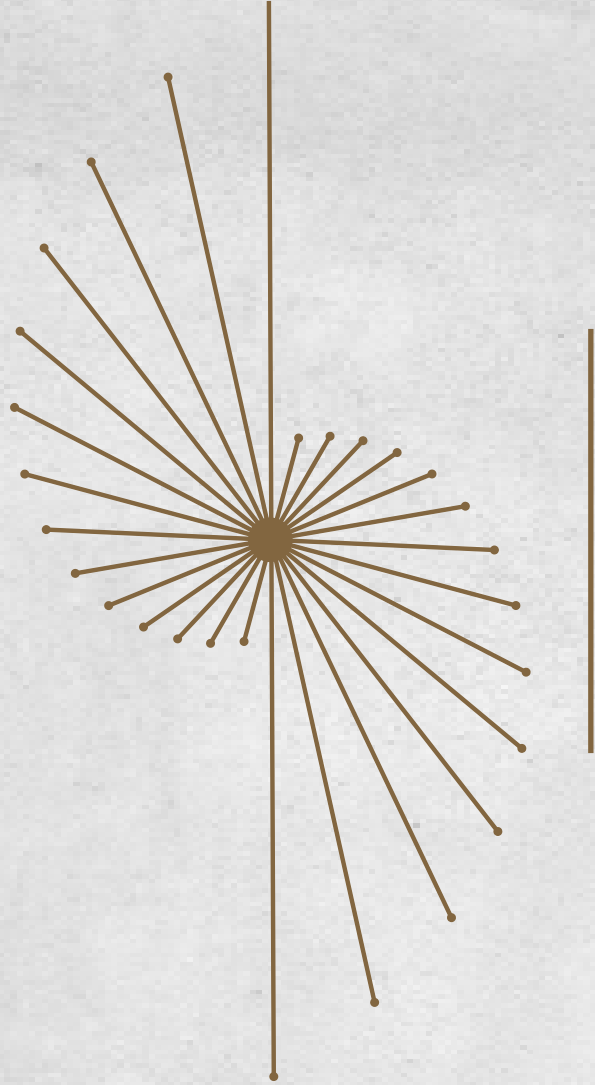

THE *NILE'S*  
NEWEST  
JEWEL

# ABOUT

SOLEIL, THE NILE'S NEWEST JEWEL, TAKES LUXURY AND ELEGANCE TO THE NEXT LEVEL. WITH HER UNIQUE DESIGN AND FEATURES, UNMATCHED LUXURY, COMBINED WITH TOP NOTCH HOSPITALITY, SOLEIL PROMISES HER GUESTS AN UNFORGETTABLE EXPERIENCE ON THE NILE. SAILING BETWEEN LUXOR AND ASWAN, GUESTS CAN ENJOY THE MAJESTIC SITES OF ANCIENT EGYPT WITH PERFECT BALANCE BETWEEN LUXURY AND AUTHENTICITY. EVERY ASPECT OF THE EXPERIENCE IS CURATED TO ENSURE OUR GUESTS LEAVE WITH LIFETIME BEST MEMORIES.





a trip to  
remember

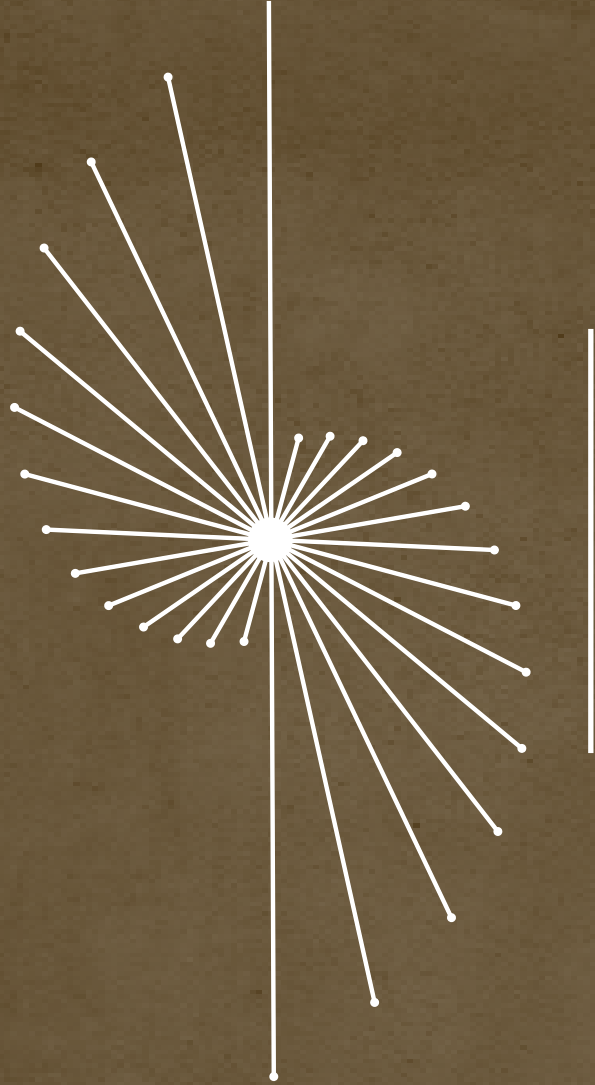

ACCOMMODATION



ENJOY THE ULTIMATE LUXURIOUS STAY ON SOLEIL NILE CRUISE WITH OUR EXQUISITELY DESIGNED ROOMS AND SUITES THAT PROVIDE BOTH COMFORT AND STYLE. OUR ROOMS AND SUITES ARE DESIGNED TO MAKE YOU FEEL PAMPERED AND RELAXED, PROVIDING THE PERFECT RETREAT AFTER A DAY OF EXPLORING THE NILE.

SOLEIL NILE CRUISE HAS 53 GUEST CABINS DIVIDED AS FOLLOWS TO PROVIDE MULTIPLE OPTIONS FOR LUXURY ACCOMMODATION: 41 LUXURY CABINS, 8 JUNIOR SUITES, 2 ROYAL SUITES, 2 SOLEIL SUITES.

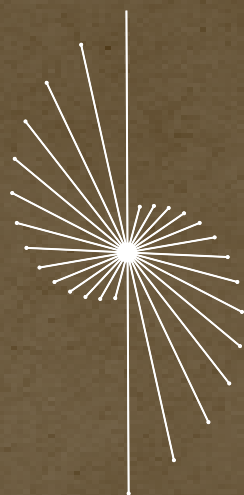

| LUXURY CABINS





Sliding  
Windows



Air Condition  
individually controlled



Non Smoking



Free WiFi



Smart TV



Safe Box



Espresso Machine



Tea & Coffee  
Station



Mini Bar



Room Service upon  
request



Laundry Service  
Upon Request



Fully Equipped  
Bathroom



Hair Dryer



Baby Cot  
Upon Request



Extra Bed  
Upon Request

## LUXURY CABIN SIZE: 21 SQM

### DESCRIPTION:

OUR 41 LUXURY CABINS ACCOMMODATE SINGLE OR DOUBLE OCCUPANCY AND CAN HAVE ONE LARGE DOUBLE BED OR TWIN BEDS. THE CABINS ARE ELEGANTLY DESIGNED WITH A FLOOR TO CEILING PRIVATE BALCONY, AND A GLASS WINDOW IN THE SHOWER WHERE YOU CAN ENJOY THE STUNNING VIEWS OF THE NILE FROM ANYWHERE IN THE CABIN.









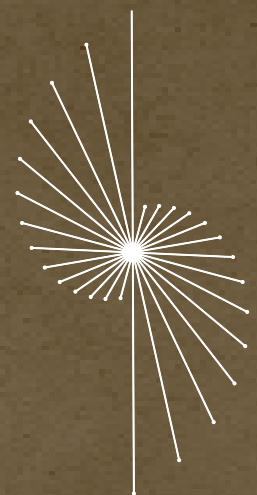

| JUNIOR SUITES





Sliding  
Windows



Air Condition  
individually controlled



Non Smoking



Free WiFi



Smart TV



Safe Box



Espresso Machine



Tea & Coffee  
Station



Mini Bar



Room Service upon  
request



Laundry Service  
Upon Request



Fully Equipped  
Bathroom



Hair Dryer



Bathtub



Baby Cot / Extra Bed  
Upon Request

## JUNIOR SUITE SIZE: 39 SQM

### DESCRIPTION:

OUR 8 JUNIOR SUITES ARE ELEGANTLY DESIGNED WITH LUXURIOUS FURNISHINGS, PROVIDING A SOPHISTICATED AND COMFORTABLE ENVIRONMENT TO ENJOY YOUR CRUISE.

THE SUITES HAVE A SEPARATE LARGE BATHROOM WITH TWO SEPARATE SINKS, SEPARATE TOILET, SEPARATE SHOWER, AND A BATHTUB OVERLOOKING THE OUTSIDE BEAUTIFUL SCENERY.















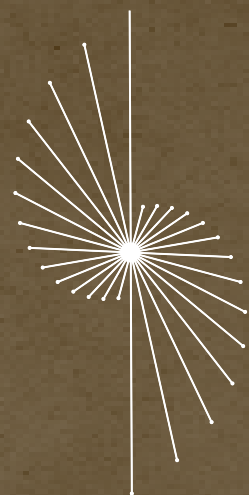

| ROYAL SUITES



Sliding  
Windows



Air Condition  
individually controlled



Non Smoking



Free WiFi



Smart TV



Safe Box



Lounge



Coffee Corner



Remote controlled  
curtains



Espresso Machine



Tea & Coffee  
Station



Mini Bar



Room Service upon  
request



Laundry Service  
Upon Request



Fully Equipped  
Bathroom



Hair Dryer



Bathtub



Baby Cot / Extra Bed  
Upon Request

## ROYAL SUITE SIZE 44 SQM

### DESCRIPTION:

THE 2 ROYAL SUITES ARE CERTAINLY AN UPGRADE IN TERMS OF SPACE AND AMBIANCE. THEY INCLUDE A NICE SOFA WHERE YOU CAN SIT BACK, RELAX AND ENJOY THE STUNNING VIEWS FROM THE LARGE FLOOR TO CEILING BALCONIES.

THE ROYAL SUITES HAVE REMOTE CONTROLLED CURTAINS, A COFFEE CORNER WITH PREMIUM BAR TOOLS, A SEPARATE LARGE BATHROOM WITH TWO SEPARATE SINKS, A SEPARATE TOILET, A SEPARATE SHOWER, AND A BATHTUB OVERLOOKING THE OUTSIDE BEAUTIFUL SCENERY. THE SUITES ENJOY A PRIVATE FIXED AND PORTABLE WIFI ROUTERS FOR BEST INTERNET SPEED AND QUALITY.















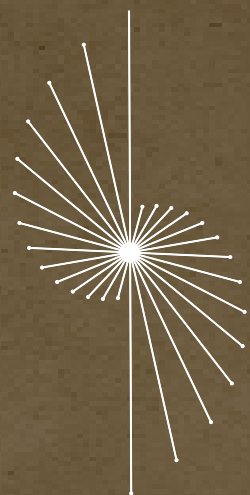

| SOLEIL SUITES





Sliding  
Windows



Air Condition  
individually controlled



Non Smoking



Free WiFi



Smart TV



Safe Box



Lounge



Dinning table



Remote controlled  
curtains



Espresso Machine



Tea & Coffee  
Station



Mini Bar



Room Service upon  
request



Laundry Service  
Upon Request



Fully Equipped  
Bathroom



Hair Dryer



Jacuzzi



Baby Cot / Extra Bed  
Upon Request

## SOLEIL SUITE SIZE 58 SQM

### DESCRIPTION:

OUR 2 SOLEIL SUITES ARE THE ULTIMATE UPGRADE TO ENJOY YOUR NILE CRUISE. THE TWO SUITES ARE SIMILAR IN SPACE AND LAYOUT, BUT EACH HAS THEIR UNIQUE STYLE AND AURA. THEY HAVE A SPACIOUS LIVING AREA, A LARGE DINING AREA WITH TWO NICE BAR CABINETS FILLED WITH TOP NOTCH BAR TOOLS & AMENITIES, SEPARATE LARGE BATHROOM, TWO SINKS, SEPARATE TOILET, SEPARATE SHOWER WITH AN ADVANCED SYSTEM, AND A JACUZZI OVERLOOKING STUNNING VIEWS OF THE NILE.

THE SUITES ENJOY REMOTE CONTROLLED CURTAINS, TWO LARGE SCREEN TVS WITH THE ABILITY TO CONTROL THE BEDROOM TV UP AND DOWN TO PROVIDE GUESTS WITH UNOBSTRUCTED VIEW OF THE SCENERY WHEN TV IS NOT IN USE. THE SUITES ALSO ENJOY PRIVATE FIXED AND PORTABLE WIFI ROUTERS FOR BEST INTERNET SPEED AND QUALITY.



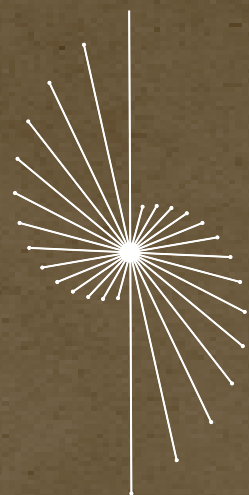

SOLEIL EAST















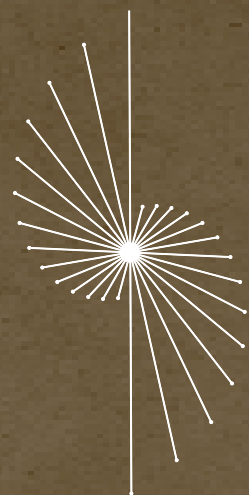

SOLEIL WEST

















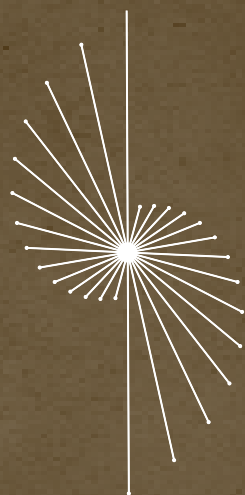

| RECEPTION





Reception  
Service



Air Condition  
individually controlled



Non Smoking



Free WiFi



Smart TV



Souvenir Shop



Lounge



Clinic



Elevator Service

## RECEPTION

### DESCRIPTION:

A GRAND ENTRY TO THE SHIP, THE RECEPTION IS ONE OF A KIND WITH ITS AUTHENTIC DESIGN, BEAUTIFUL MARBLE, UNIQUE ART PIECES AND FLOOR TO CEILING WINDOWS STRETCHING OVER TWO FLOORS.









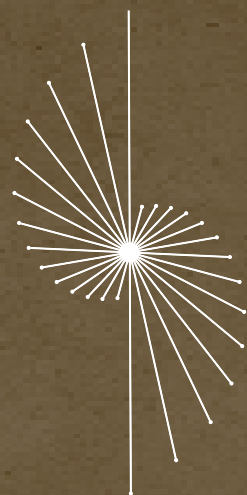

| LOUNGE BAR





Drinks



Corkage Service



Non Smoking



Free WiFi



Smart TV



Air Condition  
individually controlled



Lounge



Entertainment



Elevator Service

## LOUNGE BAR SIZE 260 SQM

### DESCRIPTION:

RELAX AND UNWIND IN THE LUXURIOUS LOUNGE, WHERE OUR ATTENTIVE AND FRIENDLY STAFF WILL ENSURE THAT YOU HAVE EVERYTHING YOU NEED. THE LOUNGE IS ALWAYS OPEN, AND IT'S A PERFECT PLACE TO SOCIALIZE WITH OTHER GUESTS OR TO SIMPLY ENJOY SOME QUIET TIME.















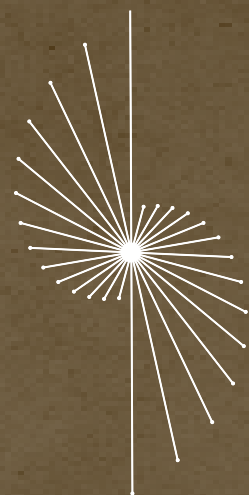

| RESTAURANT





Full board meals



Buffet & Set Menu



Drinks



Free WiFi



Non Smoking



Air Condition  
individually controlled



Baby high chair



Entertainment



Elevator Service

## RESTAURANT SIZE 280 SQM - 110 SEATS

### DESCRIPTION:

INDULGE IN A FINE DINING EXPERIENCE ON BOARD SOLEIL NILE CRUISE. OUR MENU INCLUDES A WIDE VARIETY OF CHOICES WITH FOCUS ON AUTHENTIC EGYPTIAN FLAVOUR. VEGAN, VEGETARIAN, GLUTEN-FREE DISHES, AND SPECIAL DIETARY OPTIONS ARE AVAILABLE UPON REQUEST.















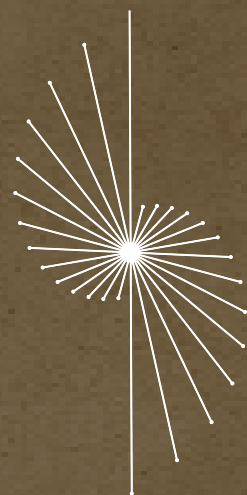

| SUNDECK & POOL





Swimming Pool



Open Air Jacuzzi



Drinks & Snacks



Free WiFi



Chaise Longue



Towels



Dinning table



Daily In-house  
music



Entertainment

## SUNDECK & POOL

### DESCRIPTION:

THE SUNDECK IS CERTAINLY THE BEST AREA TO ENJOY THE BEAUTIFUL SCENERY WHILE SAILING. OPEN ALL DAY WHERE GUESTS CAN SUNBATHE, TAKE A DIP IN THE POOL, HAVE A NICE COCKTAIL DURING THE DAY, OR A NIGHT CAP UNDER THE STARS.



















Indoor Pool



Chaise Longue



Towels



Sauna



Steam Room



Deep tissue  
Massage



Facial Massage



Reception  
Service



Free WiFi

## SPA

### DESCRIPTION:

OUR SPA SIZE AND FACILITIES ARE SIMPLY UNMATCHED ON THE NILE, ESPECIALLY OUR INDOOR LARGE MARBLE JACUZZI WITH ITS CUTTING-EDGE DESIGN AND FLOOR TO CEILING WINDOWS STRETCHING OVER TWO FLOORS. THE SPA ALSO FEATURES TWO PRIVATE MASSAGE ROOMS, ONE FOR SINGLE USE AND ONE FOR COUPLE USE, CHIC COMFORTABLE LOUNGE BEDS TO RELAX AND UNWIND, A SAUNA, A STEAM ROOM, AND A SHOWER.











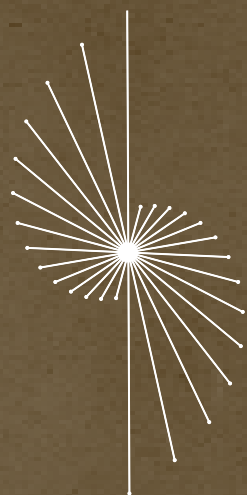

GYM





Treadmill



Bike



Multi Gym



Dumbbell set



Yoga mat



Rope



Smart TV



Air Condition  
individually controlled



Free WiFi

## GYM

### DESCRIPTION:

OUR GYM FEATURES A RANGE OF CARDIO EQUIPMENT, INCLUDING TREADMILL AND STATIONARY BIKE. WE ALSO HAVE A WIDE RANGE OF WEIGHT TRAINING EQUIPMENT INCLUDING A MULTI-GYM, BENCH, DUMBBELLS, RESISTANCE BANDS, KETLLLEBELLS AND MEDICINE BALLS, AND WE HAVE MATS TO ENJOY A YOGA OR PILATES SESSION IN THE GYM OR ON THE SUN DECK.





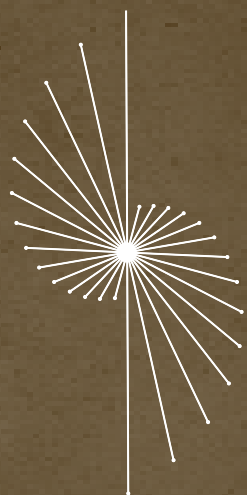

# | DECK PLAN

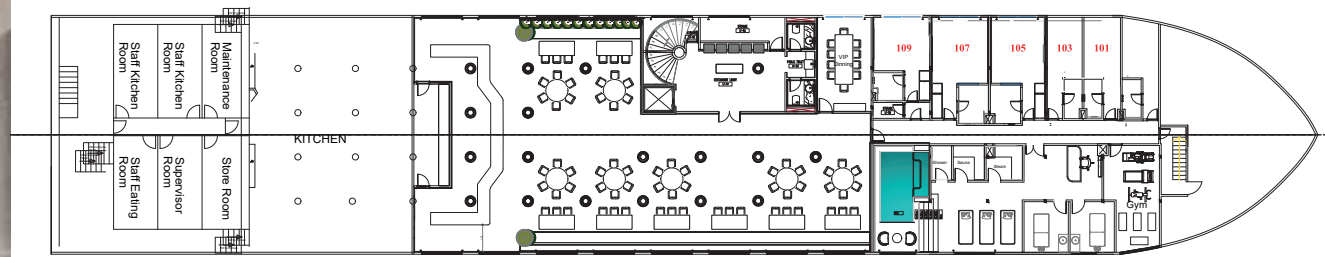

LOWER DECK PLAN

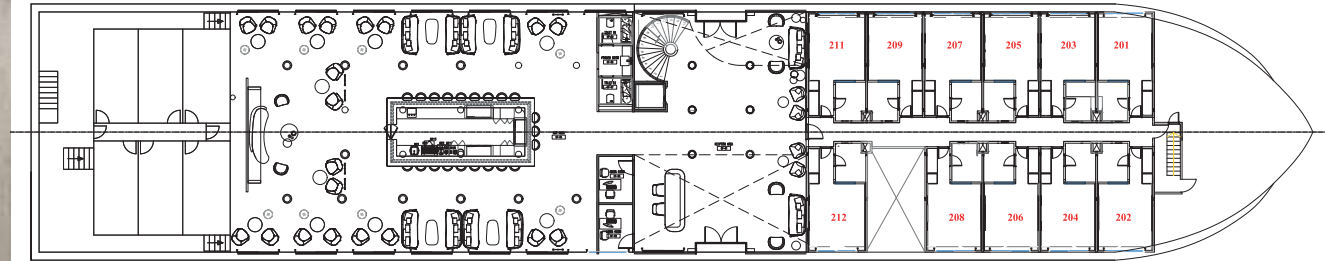

MAIN DECK PLAN

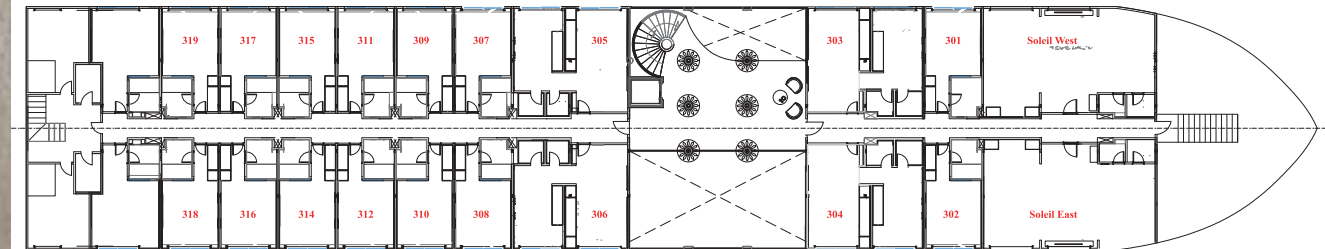

FIRST FLOOR PLAN

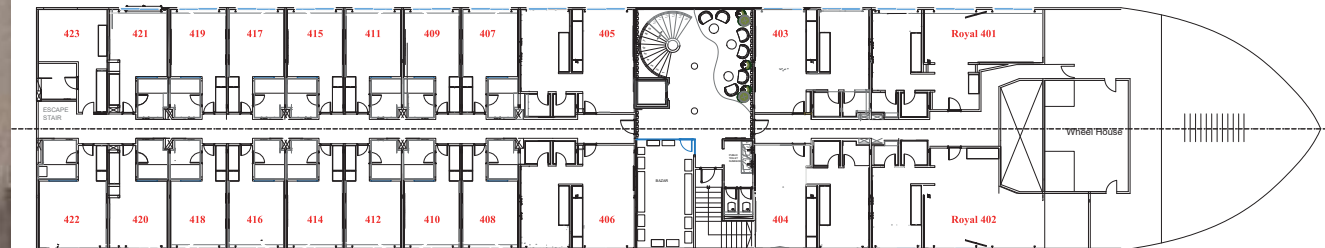

SECOND FLOOR PLAN

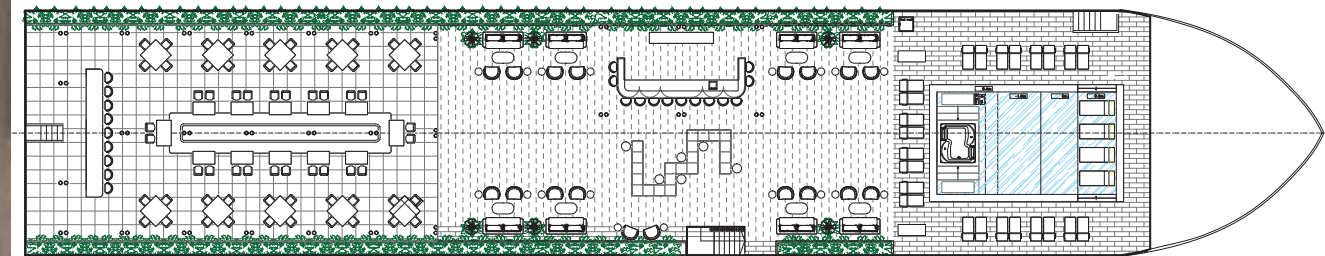

SUNDECK PLAN



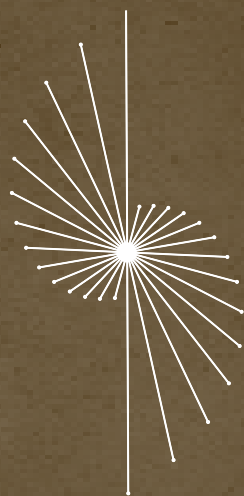

ITINERARY



## 3 Nights itinerary

### FRIDAY

- VISIT ABU SIMBEL TEMPLES (OPTIONAL)
- VISIT PHILAE TEMPLE
- CHECK-IN STARTING 12:00PM
- LUNCH
- TOUR OF ASWAN NATURAL RESERVE ON SMALL BOATS AND VISIT NUBIAN HOUSE
- DINNER
- EVENING ENTERTAINMENT
- OVERNIGHT IN ASWAN

### SATURDAY

- SAIL TO KOM OMBO
- BREAKFAST
- VISIT KOM OMBO TEMPLE
- SAIL TO EDFU
- LUNCH
- VISIT EDFU TEMPLE
- SAIL TO LUXOR VIA ESNA
- DINNER
- EVENING ENTERTAINMENT
- OVERNIGHT IN LUXOR

### SUNDAY

- HOT AIR BALLOON (OPTIONAL)
- BREAKFAST
- VISIT LUXOR WEST BANK
  - VALLEY OF THE KINGS
  - HATSHEPSUT TEMPLE
  - COLOSSI OF MEMNON
- LUNCH
- VISIT KARNAK TEMPLES
- VISIT LUXOR TEMPLE
- DINNER
- ENTERTAINMENT
- OVERNIGHT IN LUXOR

### MONDAY

- CHECK-OUT BY 8:00AM





## 4 Nights itinerary

### MONDAY

- CHECK-IN STARTING 12:00 PM
- LUNCH
- VISIT KARNAK TEMPLES
- VISIT LUXOR TEMPLE
- DINNER
- EVENING ENTERTAINMENT
- OVERNIGHT IN LUXOR

### TUESDAY

- HOT AIR BALLOON (OPTIONAL)
- BREAKFAST
- VISIT LUXOR WEST BANK:
  - VALLEY OF THE KINGS
  - HATSHEPSUT TEMPLE
  - COLOSSI OF MEMNON
- SAIL TO EDFU VIA ESNA LOCK
- LUNCH
- DINNER
- EVENING ENTERTAINMENT
- OVERNIGHT IN EDFU

### WEDNESDAY

- BREAKFAST
- VISIT EDFU TEMPLE (BY HORSE CARRIAGES)
- SAIL TO KOM OMBO
- LUNCH
- VISIT KOM OMBO TEMPLE
- SAIL TO ASWAN
- DINNER
- EVENING ENTERTAINMENT
- OVERNIGHT IN ASWAN

### THURSDAY

- BREAKFAST
- VISIT PHILAE TEMPLE
- LUNCH
- TOUR OF ASWAN NATURAL RESERVE ON SMALL BOATS AND VISIT NUBIAN HOUSE
- DINNER
- EVENING ENTERTAINMENT
- OVERNIGHT IN ASWAN

### FRIDAY

- VISIT ABU SIMBEL TEMPLES (OPTIONAL)
- BREAKFAST
- CHECK-OUT BY 8:00 AM





# 7 Nights itinerary from Aswan

## FRIDAY

- VISIT ABU SIMBEL TEMPLES (OPTIONAL)
- VISIT PHILAE TEMPLE
- CHECK-IN STARTING 12:00PM
- LUNCH
- TOUR OF ASWAN NATURAL RESERVE ON SMALL BOATS & VISIT NUBIAN HOUSE
- DINNER
- EVENING ENTERTAINMENT
- OVERNIGHT IN ASWAN

## SATURDAY

- SAIL TO KOM OMBO
- BREAKFAST
- VISIT KOM OMBO TEMPLE
- SAIL TO EDFU
- LUNCH
- SAIL TO LUXOR VIA ESNA
- DINNER
- EVENING ENTERTAINMENT
- OVERNIGHT IN LUXOR

## SUNDAY

- BREAKFAST
- LUNCH
- VISIT KARNAK TEMPLES
- VISIT LUXOR TEMPLE
- DINNER
- EVENING ENTERTAINMENT
- OVERNIGHT IN LUXOR

## MONDAY

- HOT AIR BALLOON (OPTIONAL)
- BREAKFAST
- VISIT LUXOR WEST BANK:
  - VALLEY OF THE KINGS
  - HATSHEPSUT TEMPLE
  - COLOSSI OF MEMNON
- LUNCH
- DINNER
- EVENING ENTERTAINMENT
- OVERNIGHT IN LUXOR

## TUESDAY

- BREAKFAST
- SAIL TO EDFU VIA ESNA LOCK
- LUNCH
- DINNER
- EVENING ENTERTAINMENT
- OVERNIGHT IN EDFU

## WEDNESDAY

- BREAKFAST
- VISIT EDFU TEMPLE (BY HORSE CARRIAGES)
- SAIL TO KOM OMBO
- LUNCH
- VISIT KOM OMBO TEMPLE
- SAIL TO ASWAN
- DINNER
- EVENING ENTERTAINMENT
- OVERNIGHT IN ASWAN

## THURSDAY

- BREAKFAST
- VISIT PHILAE TEMPLE
- LUNCH
- DINNER
- EVENING ENTERTAINMENT
- OVERNIGHT IN ASWAN

## FRIDAY

- BREAKFAST
- CHECK-OUT BY 8:00 AM





# 7 Nights itinerary from Luxor

## MONDAY

- CHECK-IN STARTING 12:00 PM
- LUNCH
- VISIT LUXOR TEMPLE
- DINNER
- EVENING ENTERTAINMENT
- OVERNIGHT IN LUXOR

## TUESDAY

- HOT AIR BALLOON (OPTIONAL)
- BREAKFAST
- VISIT LUXOR WEST BANK:
  - VALLEY OF THE KINGS
  - HATSHEPSUT TEMPLE
  - COLOSSI OF MEMNON
- SAIL TO EDFU VIA ESNA LOCK
- LUNCH
- DINNER
- EVENING ENTERTAINMENT
- OVERNIGHT IN EDFU

## WEDNESDAY

- BREAKFAST
- VISIT EDFU TEMPLE (BY HORSE CARRIAGES)
- SAIL TO KOM OMBO
- LUNCH
- SAIL TO ASWAN
- DINNER
- EVENING ENTERTAINMENT
- OVERNIGHT IN ASWAN

## THURSDAY

- BREAKFAST
- VISIT PHILAE TEMPLE
- LUNCH
- DINNER
- EVENING ENTERTAINMENT
- OVERNIGHT IN ASWAN

## FRIDAY

- VISIT ABU SIMBEL TEMPLES (OPTIONAL)
- BREAKFAST
- LUNCH
- TOUR OF ASWAN NATURAL RESERVE ON SMALL BOATS AND VISIT NUBIAN HOUSE NATURAL RESERVE
- DINNER
- EVENING ENTERTAINMENT
- OVERNIGHT IN ASWAN

## SATURDAY

- SAIL TO KOM OMBO
- BREAKFAST
- VISIT KOM OMBO TEMPLE
- LUNCH
- SAIL TO LUXOR VIA ESNA
- DINNER
- EVENING ENTERTAINMENT
- OVERNIGHT IN LUXOR

## SUNDAY

- BREAKFAST
- VISIT KARNAK TEMPLES
- LUNCH
- DINNER
- EVENING ENTERTAINMENT
- OVERNIGHT IN LUXOR

## MONDAY

- BREAKFAST
- CHECK-OUT BY 8:00 AM

[WWW.SOLEIL-CRUISE.COM](http://WWW.SOLEIL-CRUISE.COM)

THANK YOU